

# Clock Tower at Mill Creek Town Center

15021 Main St, Mill Creek, WA, 98012

Retail

Prepared on March 22, 2022

0



## Property Features

### Location Details

Address	15021 Main St, Mill Creek, WA 98012
Zoning	PCB
Submarket	CBA Mill Creek
County	Snohomish

Parcels	27050600203000
Name	Clock Tower at Mill Creek Town Center
Center/Park Name	Mill Creek Town Center
Cross Street	151st St Se

### Building Details

Sub Type	-
Building Status	Existing
Building Size	18,867 SF
Land Size	1.73 Acres / 75,359 SF
Number of Buildings	1
Number of Floors	1
Year Built	2006
Primary Constr. Type	Masonry
Occupancy Type	Multi-tenant

Percent Occupied	91.83%
Parking Spaces	82
Parking Ratio	-
Retail Space	18,867 SF
Rentable Space	18,867 SF
Air Conditioned	Yes
Security System	No
Rail Service	No

## Listings

1 Listing | 1,541 SF | \$32.00 Annual/SF

Type	Condo	Space Use	Suite	Available Space	Rate	Available
For Lease	No	Retail	-	1,541 SF	\$32.00 Annual/SF NNN	4/01/2022

## Contact

---



**Natalie Foskey, CCIM**  
425-343-7176  
natalie@key-cc.com



Key Choice Commercial

## Mill Creek Town Center 1,541/SF End Cap, R...

15021 Main St, Mill Creek, WA, 98012

Retail For Lease

Prepared on March 22, 2022

1 of 1 Listings



### Listing Details | Retail For Lease

Suite	-	Divisible	Not present
Sublease	-	Vacant	Yes
Total Available Space	1,541 SF	Available Date	4/01/2022
Min Div/Max Contig	-	Date Listed	3/16/2022
Asking Rate	\$32.00 Annual/SF	Last Modified	3/17/2022
Monthly Rate	\$4,109	Listing ID	30116812
Lease Type	NNN	Parking Spaces	-
Expenses	\$9.11		

### Description

This End Cap space has high exposure off Bothell-Everett Highway.

Take advantage of this rare opportunity to locate your business in the Mill Creek Town Center, recognized in 2013 as the Official Best Lifestyle Center & Open-Air Mall in Washington.

The Clock Tower building is located directly across the street from LA Fitness.

29,137 - Average Daily Traffic Count, 151st & Bothell Everett Hwy

- Class A Office Build-out -

Four Offices, Reception Area, IT Office, Kitchen

You will join these established tenants:

Thai Rhapsody

First Financial NW Bank

HomeBridge Mortgage

Barre3

Dream Dinners

Nail Masters

Airrostri

## Property Features

### Location Details

Address	15021 Main St, Mill Creek, WA 98012
Zoning	PCB
Submarket	CBA Mill Creek
County	Snohomish

Parcels	27050600203000
Name	Clock Tower at Mill Creek Town Center
Center/Park Name	Mill Creek Town Center
Cross Street	151st St Se

### Building Details

Sub Type	-
Building Status	Existing
Building Size	18,867 SF
Land Size	1.73 Acres / 75,359 SF
Number of Buildings	1
Number of Floors	1
Year Built	2006
Primary Constr. Type	Masonry
Occupancy Type	Multi-tenant

Percent Occupied	91.83%
Parking Spaces	82
Parking Ratio	-
Retail Space	18,867 SF
Rentable Space	18,867 SF
Air Conditioned	Yes
Security System	No
Rail Service	No

### Property Listings

1 Listing | 1,541 SF | \$32.00 Annual/SF

Type	Condo	Space Use	Suite	Available Space	Rate	Available
For Lease	No	Retail	-	1,541 SF	\$32.00 Annual/SF NNN	4/01/2022

### Contact



**Natalie Foskey, CCIM**  
425-343-7176  
natalie@key-cc.com



Key Choice Commercial

# Clock Tower at Mill Creek Town Center



Key Choice Commercial 6116 211th St. SW #203 Lynnwood, WA 98036 | 425-658-3288



Natalie Foskey, CCIM  
natalie@key-cc.com  
425-343-7176



This information supplied herein is from sources we deem reliable. It is provided without any representation, warranty or guarantee, expressed or implied as to its accuracy. Prospective Buyer or Tenant should conduct an independent investigation and verification of all matters deemed to be material, including, but not limited to, statements of income and expenses. Consult your attorney, accountant, or other professional advisor



# Clock Tower at Mill Creek Town Center



Key Choice Commercial 6116 211th St. SW #203 Lynnwood, WA 98036 | 425-658-3288

Parcel  
Aerial



# Clock Tower at Mill Creek Town Center

15021 Main St  
Mill Creek, WA 98012



Natalie Foskey, CCIM  
natalie@key-cc.com  
425-343-7176



This information supplied herein is from sources we deem reliable. It is provided without any representation, warranty or guarantee, expressed or implied as to its accuracy. Prospective Buyer or Tenant should conduct an independent investigation and verification of all matters deemed to be material, including, but not limited to, statements of income and expenses. Consult your attorney, accountant, or other prof. advisor.

# Location Facts & Demographics

Demographics are determined by a 10 minute drive from 15021 Main St, Mill Creek, WA 98012

CITY, STATE

Mill Creek, WA

POPULATION

95,082

AVG. HH SIZE

2.71

MEDIAN HH INCOME

\$89,561

HOME OWNERSHIP

Renters: 13,291

Owners: 22,776

EMPLOYMENT

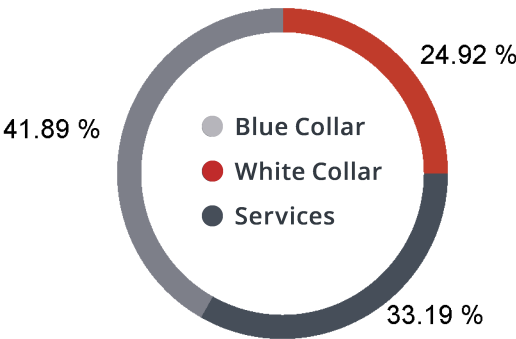

52.34 %  
Employed

1.59 %  
Unemployed

EDUCATION

High School Grad: 20.90 %  
Some College: 27.92 %  
Associates: 9.07 %  
Bachelors: 35.65 %

GENDER & AGE

49.95 % 50.05 %

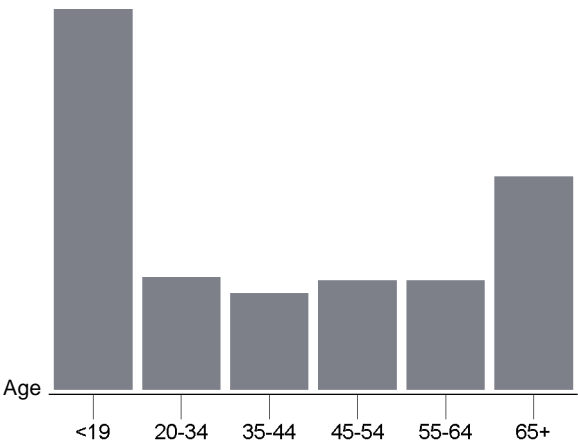

RACE & ETHNICITY

White: 68.78 %  
Asian: 13.24 %  
Native American: 0.21 %  
Pacific Islanders: 0.03 %  
African-American: 2.20 %  
Hispanic: 8.22 %  
Two or More Races: 7.32 %

INCOME BY HOUSEHOLD

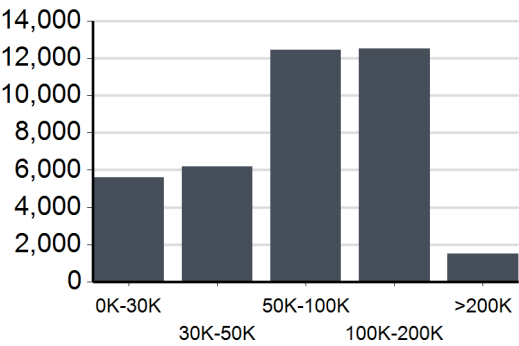

HH SPENDING

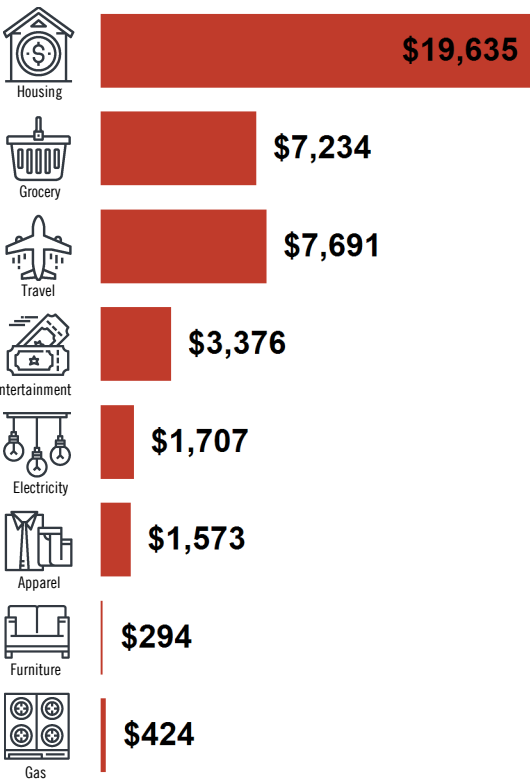



# Clock Tower at Mill Creek Town Center



Key Choice Commercial

6116 211th St. SW #203 Lynnwood, WA 98036 | 425-658-3288

## Traffic Counts

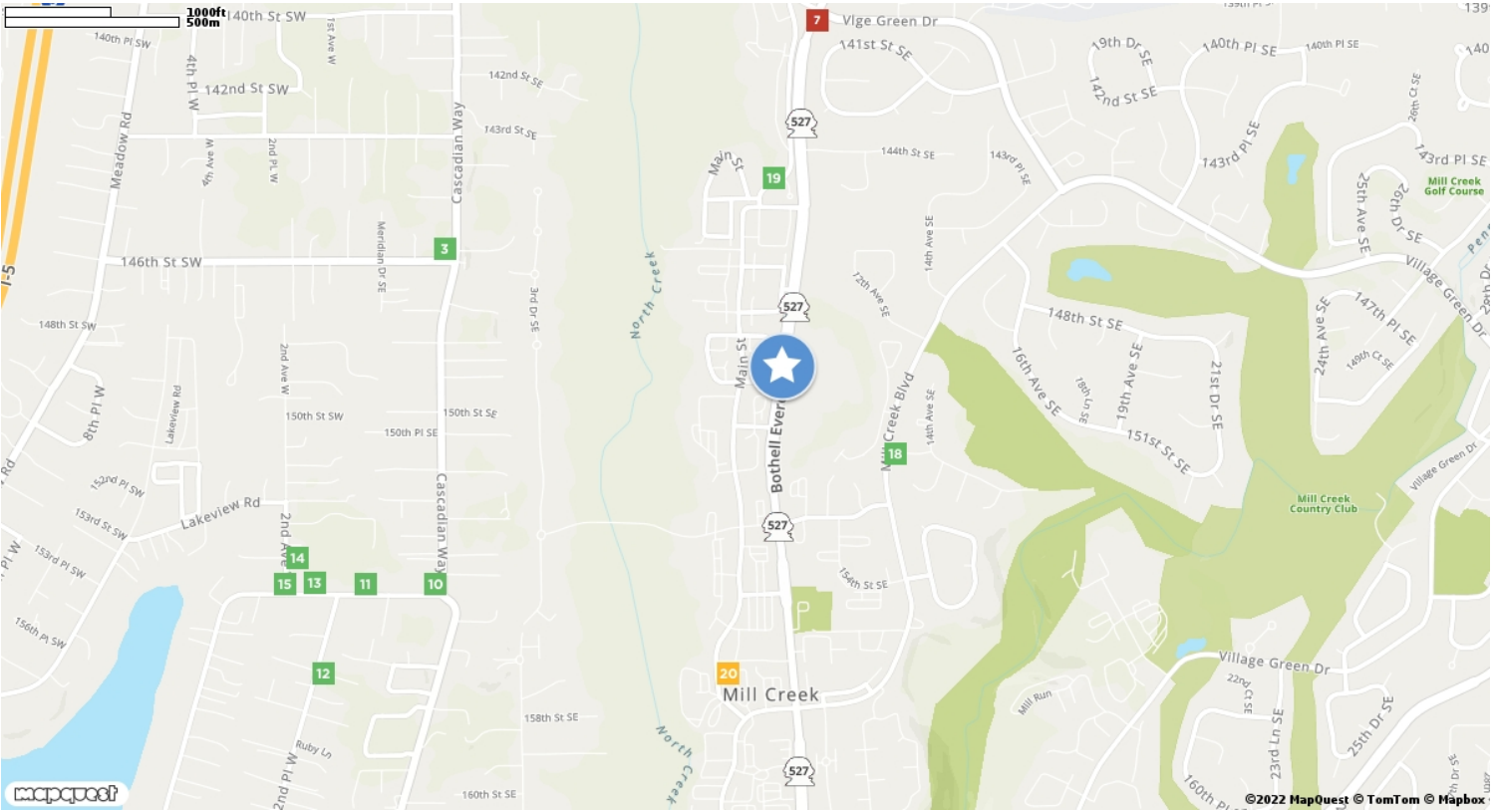

<b>Bothell-Everett Highway 1</b> 138th St SE Year: 2021 29,896 est Year: 2019 31,000 Year: 2018 32,000	<b>Bothell-Everett Highway 2</b> 164th St SE Year: 2021 35,185 est Year: 2019 36,000 Year: 2017 36,000	<b>146th St SE 3</b> Cascadian Way Year: 2021 901 est Year: 2018 968 Year: 2014 792	<b>Bothell-Everett Highway 4</b> Bothell Everett Hwy Year: 2021 30,176 est Year: 2018 30,000	<b>Bothell-Everett Highway 5</b> Bothell Everett Hwy Year: 2021 36,211 est Year: 2018 36,000
<b>Bothell Everett Hwy 6</b> 138th St SE Year: 2021 21,662 est Year: 2018 23,000 Year: 2015 22,000	<b>Bothell Everett Hwy 7</b> Trillium Blvd Year: 2021 30,426 est Year: 2017 32,000 Year: 2010 25,490	<b>Bothell Everett Hwy 8</b> N Creek Dr Year: 2021 24,738 est Year: 2017 23,000 Year: 2010 27,870	<b>Bothell Everett Hwy 9</b> 164th St SE Year: 2021 29,363 est Year: 2017 30,000 Year: 2015 29,000	<b>155th St SE 10</b> Cascadian Way Year: 2021 1,878 est Year: 2016 1,975 Year: 2012 1,670
<b>155th St SW 11</b> 2nd Pl W Year: 2021 1,989 est Year: 2016 1,975 Year: 2001 1,554	<b>2nd Pl W 12</b> 157th Pl SW Year: 2021 980 est Year: 2016 973	<b>155th St SW 13</b> 2nd Pl W Year: 2021 1,293 est Year: 2015 1,282 Year: 1998 1,502	<b>2nd Ave W 14</b> 154th St SW Year: 2021 972 est Year: 2015 964 Year: 1998 1,290	<b>155th St SW 15</b> 3rd Pl W Year: 2021 1,247 est Year: 2015 1,236 Year: 1998 830
<b>164th St SE 16</b> Bothell Everett Hwy Year: 2021 26,239 est Year: 2014 27,300 Year: 2010 23,300	<b>164th St SE 17</b> Bothell Everett Hwy Year: 2021 17,830 est Year: 2014 17,150 Year: 2013 18,142	<b>Mill Creek Blvd 18</b> 151st Pl SE Year: 2021 4,796 est Year: 2013 4,789 Year: 2010 4,654	<b>N Creek Dr 19</b> The Reserve at Town Center Year: 2021 2,090 est Year: 2013 2,128	<b>Main St 20</b> Mill Creek Blvd Year: 2021 6,194 est Year: 2013 6,517 Year: 2010 6,065



Natalie Foskey, CCIM  
 natalie@key-cc.com  
 425-343-7176



This information supplied herein is from sources we deem reliable. It is provided without any representation, warranty or guarantee, expressed or implied as to its accuracy. Prospective Buyer or Tenant should conduct an independent investigation and verification of all matters deemed to be material, including, but not limited to, statements of income and expenses. Consult your attorney, accountant, or other prof. advisor.