

For Lease

Key Choice
COMMERCIAL REAL ESTATE

Bell East Business Park - Building 3

Retail \$25.00 PSF + NNN

5,800 SF (Suite B7)



Bell East Business Park - Building 3
1910 132nd Ave NE, Bellevue, WA 98005



Natalie Foskey, CPM, CCIM
Designated Broker

425-343-7176

Natalie@Key-CC.com
License Number 26699

Shivani Sterling
Sales & Leasing Broker

425-503-1678

Shivani@Key-CC.com
License Number 138760

6116 211th St. SW #203 Lynnwood, WA 98036 | 425-658-3288 | KEYCHOICECOMMERCIAL.COM

FOR LEASE

Retail \$25.00 PSF + NNN
5,800 SF (Suite B7) Available

Bell East Business Park - Building 3
1910 132ND AVE NE, SUITE B7
BELLEVUE, WA 98005

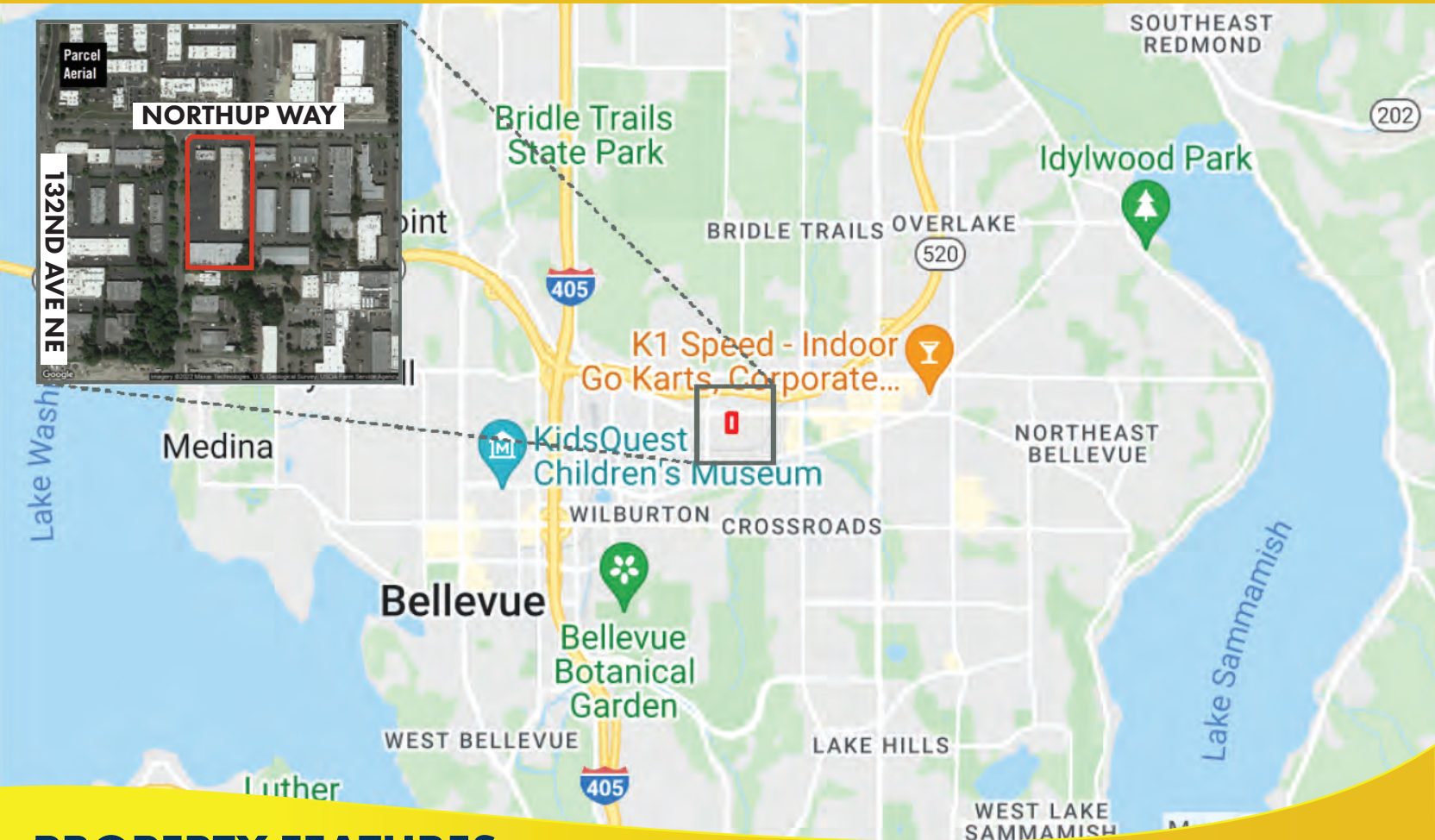

PROPERTY FEATURES

BUILDING SIZE	38,400 SF
LEASABLE SF	5,800 SF
ANNUAL RATE/SF	\$25.00
LEASE TYPE	NNN
CROSS STREET	NE 20TH/Northup Way



FOR LEASE

Retail \$25.00 PSF + NNN

5,800 SF (Suite B7) Available

Bell East Business Park - Building 3

1910 132ND AVE NE, SUITE B7

BELLEVUE, WA 98005

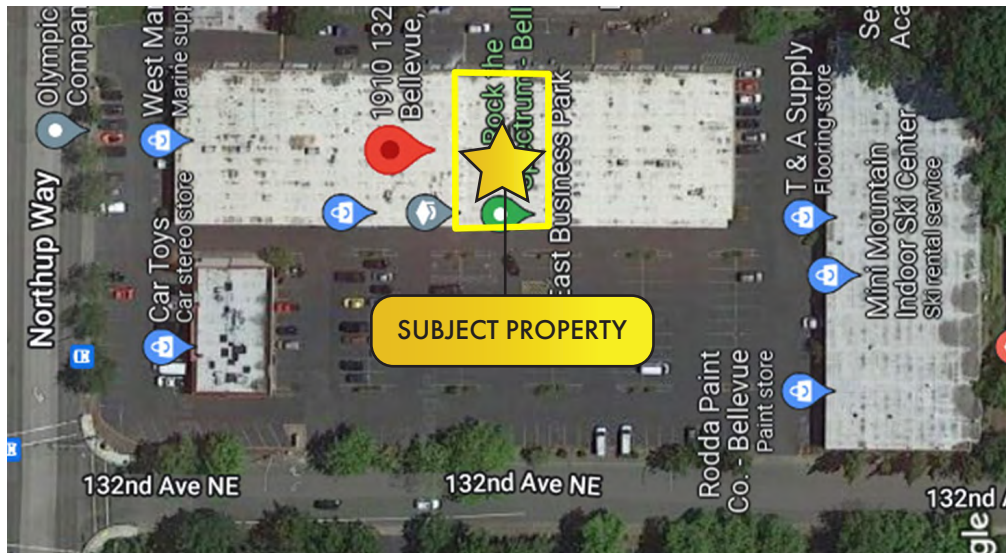

DEMOGRAPHICS

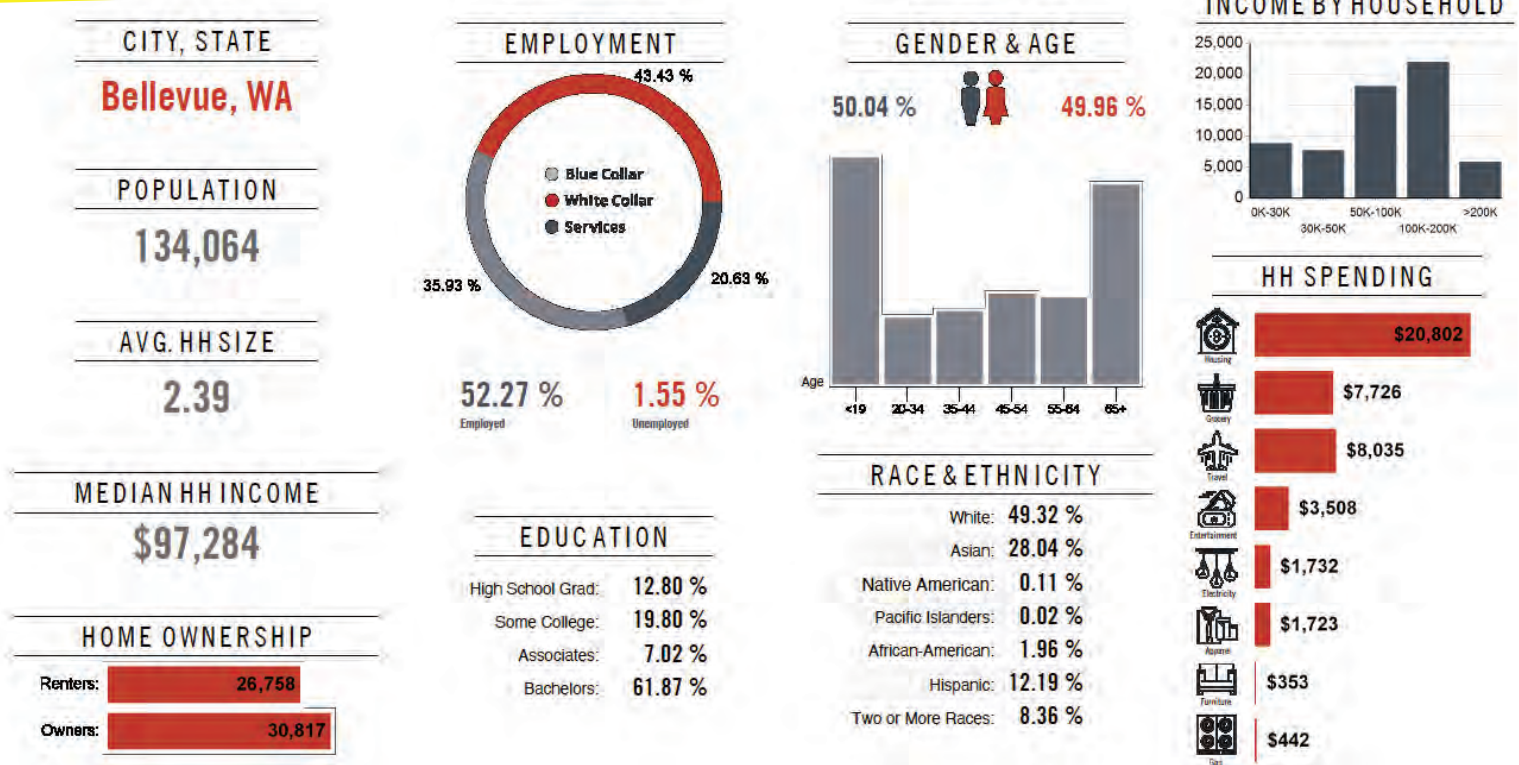

Demographics are determined by a 10 minute drive from the subject property



Firm License #7894

6116 211th St. SW #203 | Lynnwood, WA 98036 | 425-658-3288 | KEYCHOICECOMMERCIAL.COM

FOR LEASE

Retail \$25.00 PSF + NNN
5,800 SF (Suite B7) Available

Bell East Business Park - Building 3
1910 132ND AVE NE, SUITE B7
BELLEVUE, WA 98005

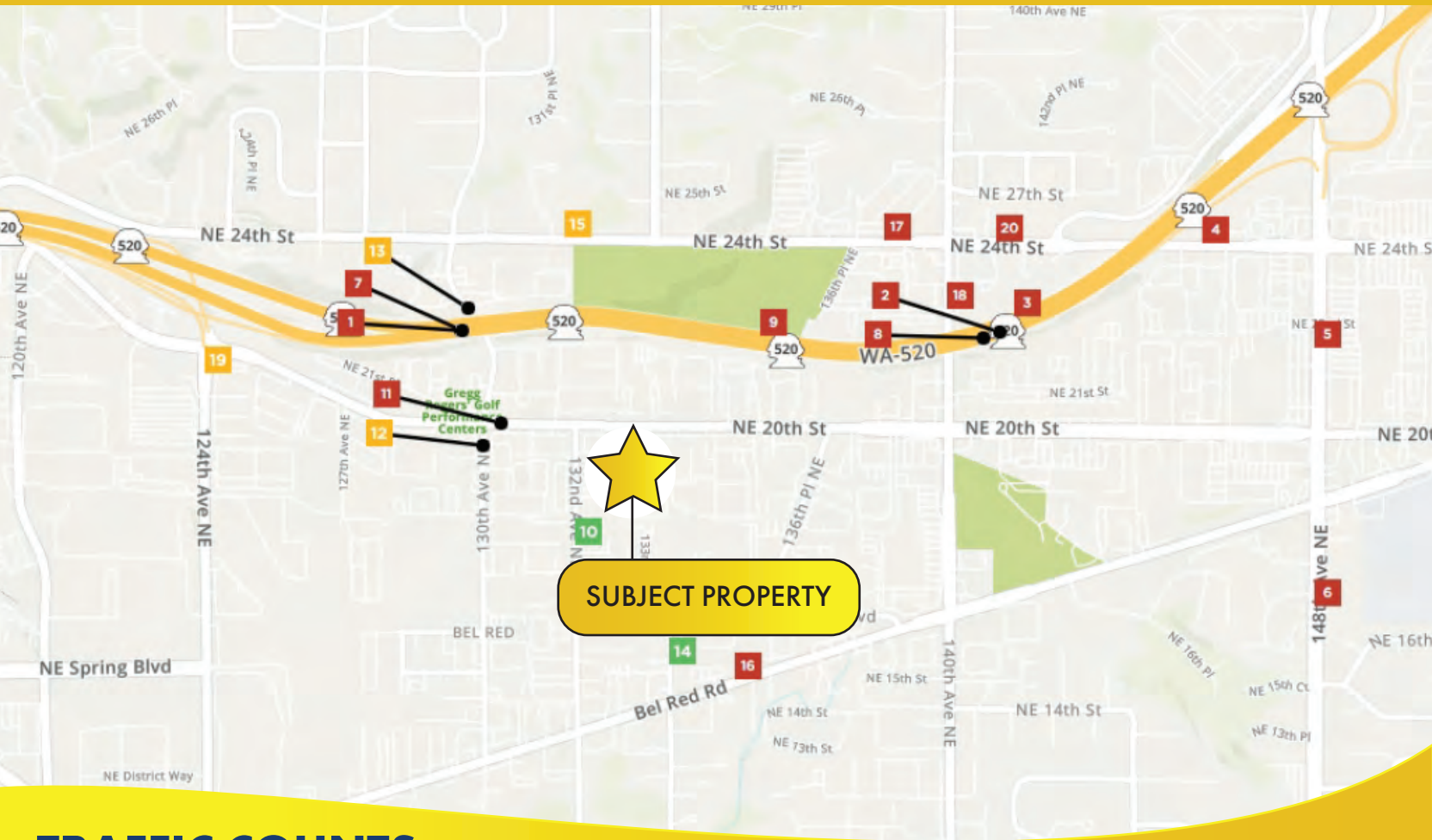

TRAFFIC COUNTS

<div>1</div> <div>Northup Way</div> <div>Year: 2021108,439 est</div> <div>Year: 2019105,000</div> <div>Year: 2010101,000</div>	<div>2</div> <div>Northup Way</div> <div>Year: 2021112,917 est</div> <div>Year: 2019105,000</div> <div>Year: 2007126,329</div>	<div>3</div> <div>State Rte 520</div> <div>140th Ave NE</div> <div>Year: 2021128,181 est</div> <div>Year: 2019126,000</div>	<div>4</div> <div>Northeast 24th Street</div> <div>NE 24th St</div> <div>Year: 202114,045 est</div> <div>Year: 201914,000</div>	<div>5</div> <div>148th Avenue Northeast</div> <div>NE 20th St</div> <div>Year: 202136,618 est</div> <div>Year: 201936,500</div>
<div>6</div> <div>148th Avenue Northeast</div> <div>NE 16th St</div> <div>Year: 202135,515 est</div> <div>Year: 201935,400</div>	<div>7</div> <div>State Rte 520</div> <div>130th Ave NE</div> <div>Year: 2021109,803 est</div> <div>Year: 2018107,000</div>	<div>8</div> <div>State Rte 520</div> <div>140th Ave NE</div> <div>Year: 2021109,599 est</div> <div>Year: 2018107,000</div> <div>Year: 2017105,000</div>	<div>9</div> <div>State Rte 520</div> <div>140th Ave NE</div> <div>Year: 2021110,016 est</div> <div>Year: 2017105,000</div> <div>Year: 201299,000</div>	<div>10</div> <div>132nd Ave NE</div> <div>NE 16th St</div> <div>Year: 20214,096 est</div> <div>Year: 20154,690</div> <div>Year: 20144,129</div>
<div>11</div> <div>NE 20th St</div> <div>130th Ave NE</div> <div>Year: 202123,592 est</div> <div>Year: 201525,257</div> <div>Year: 201423,959</div>	<div>12</div> <div>130th Ave NE</div> <div>NE 20th St</div> <div>Year: 20216,335 est</div> <div>Year: 20156,465</div> <div>Year: 20146,522</div>	<div>13</div> <div>130th Ave NE</div> <div>State Hwy520</div> <div>Year: 20216,164 est</div> <div>Year: 20156,423</div> <div>Year: 20146,883</div>	<div>14</div> <div>134th Ave NE</div> <div>Bel Red Rd</div> <div>Year: 20212,021 est</div> <div>Year: 20151,961</div> <div>Year: 20141,996</div>	<div>15</div> <div>NE 24th St</div> <div>131st Pl NE</div> <div>Year: 20218,848 est</div> <div>Year: 20158,110</div> <div>Year: 20147,938</div>
<div>16</div> <div>Bel Red Rd</div> <div>134th Ave NE</div> <div>Year: 202123,268 est</div> <div>Year: 201524,273</div> <div>Year: 201423,704</div>	<div>17</div> <div>NE 24th St</div> <div>136th Pl NE</div> <div>Year: 202110,158 est</div> <div>Year: 201510,553</div> <div>Year: 20149,762</div>	<div>18</div> <div>140th Ave NE</div> <div>State Hwy520</div> <div>Year: 202122,908 est</div> <div>Year: 201523,400</div> <div>Year: 201423,482</div>	<div>19</div> <div>124th Ave NE</div> <div>Northup Way</div> <div>Year: 20217,406 est</div> <div>Year: 20158,172</div> <div>Year: 20147,072</div>	<div>20</div> <div>NE 24th St</div> <div>140th Ave NE</div> <div>Year: 202115,161 est</div> <div>Year: 201513,675</div> <div>Year: 201413,810</div>

FOR LEASE

Retail \$25.00 PSF + NNN
5,800 SF (Suite B7) Available

Bell East Business Park - Building 3
1910 132ND AVE NE, SUITE B7
BELLEVUE, WA 98005



Located between 130th and 132nd Avenues Northeast at Northeast Spring Boulevard, this station includes 300 parking spaces and supports future transit oriented development in Bellevue's new Spring District neighborhood.

